



Special Element Fenders.

Characteristics

- ▶ Economical alternative to steel panels
- ▶ Flexible fender system
- ▶ Low friction facing

Applications

- ▶ Container & Bulk Terminals
- ▶ Jetties and berths for small to medium size vessels
- ▶ Bulk Terminals
- ▶ General Cargo Terminals
- ▶ Navy

SAFIM AS AGENT

SPECIAL ELEMENT FENDER DIMENSIONS

Fender Size	H [mm]	Type 1			Type 2			Type 3			T [mm]	Anchors/ Bolts	Weight* [kg/m]
		A [mm]	B [mm]	C [mm]	A [mm]	B [mm]	C [mm]	A [mm]	B [mm]	C [mm]			
FE-S 250	250	300	380	230	300	380	320	390	470	320	70	M20	30
FE-S 300	300	360	454	270	360	454	410	500	594	410	70	M24	46
FE-S 400	400	480	606	360	480	606	500	620	746	500	80	M24	66
FE-S 500	500	600	774	460	600	774	660	800	972	660	90	M30	111
FE-S 550	550	660	834	500	660	834	750	910	1,084	750	90	M30	132
FE-S 600	600	720	894	530	720	894	800	990	1,164	800	90	M30	153
FE-S 700	700	840	1,066	640	840	1,066	930	1,130	1,356	930	100	M36	222
FE-S 750	750	900	1,136	680	900	1,136	1,010	1,230	1,466	1,010	100	M36	239
FE-S 800	800	960	1,218	730	960	1,218	1,170	1,400	1,658	1,170	100	M36	268
FE-S 1000	1,000	1,200	1,524	910	1,200	1,524	1,330	1,620	1,944	1,330	120	M42	454
FE-S 1250	1,250	1,500	1,904	1,130	1,500	1,904	1,660	2,030	2,434	1,660	120	M48	639

Larger sizes available upon request
 * Weight for single F E Fender unit

SPECIAL ELEMENT FENDER DRAWING WITHOUT BELT DEFLECTOR

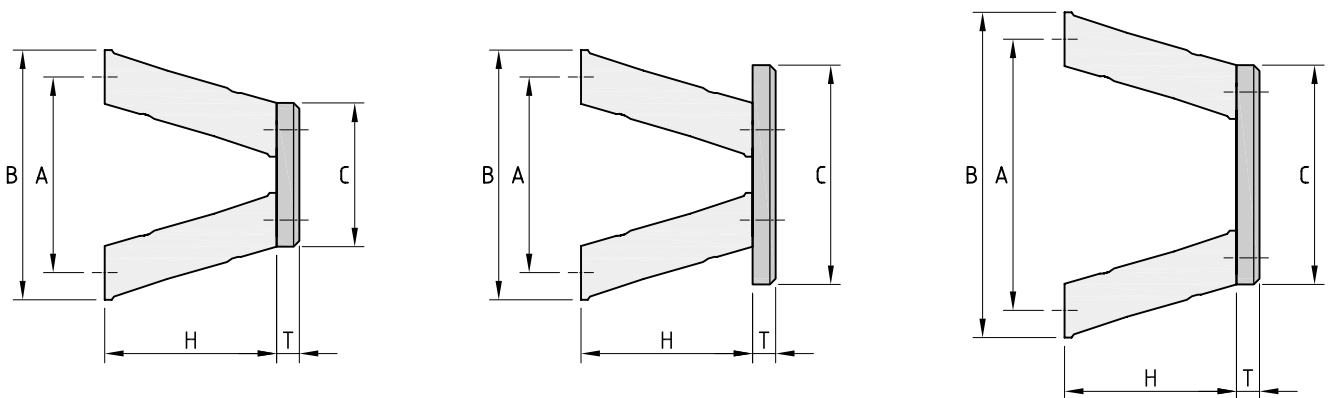



Si erdok | Gent | Belgium



Punta del Este | Montevideo | Uruguay



Ethanol Jetty | Stenungsund | Sweden



Ferry & RoRo Terminal | Malmö | Sweden

SPECIAL ELEMENT FENDER DRAWING WITH BELT DEFLECTOR

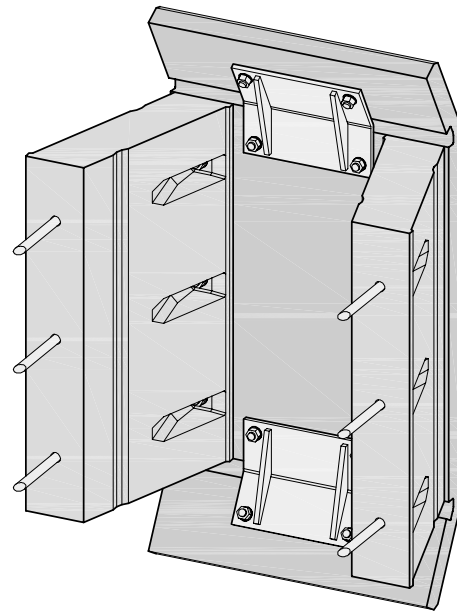
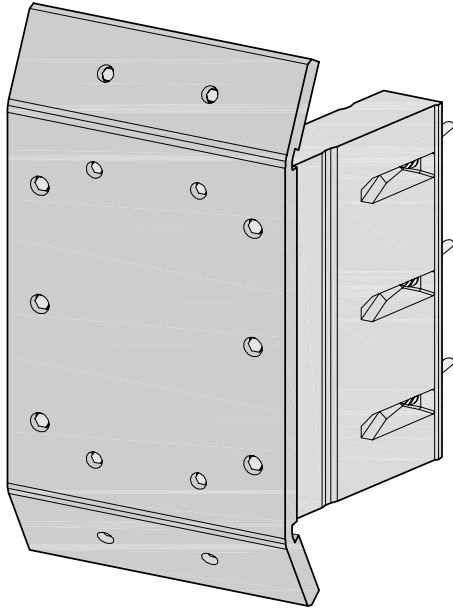

Northern Berth 16 | Port of Gdynia | Poland